



1100



TENSIO



30 - 40 min

S1 **4\*12**



x2

S2 **8\*25**



x8

S3 **8\*16**



x13

S4 **5\*16**



x2

S5 **4\*14**



x28

S6 **6mm**



x1

S7 **3mm**



x1

S8



x3

S9



x4

G



x1

H



x2

I



x2

J



x2

A

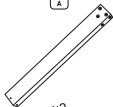

x2

B



x2

C



x2

D



x1

E



x1

F



x1

K



x1

M



x1

N



x1

# 1

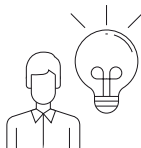
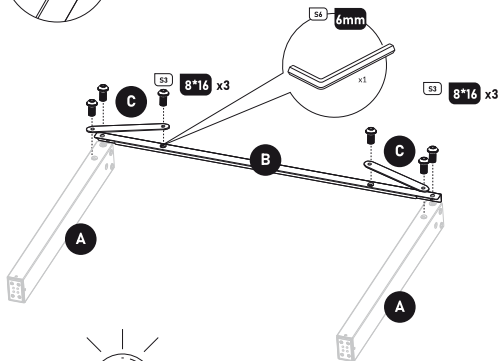

# 2

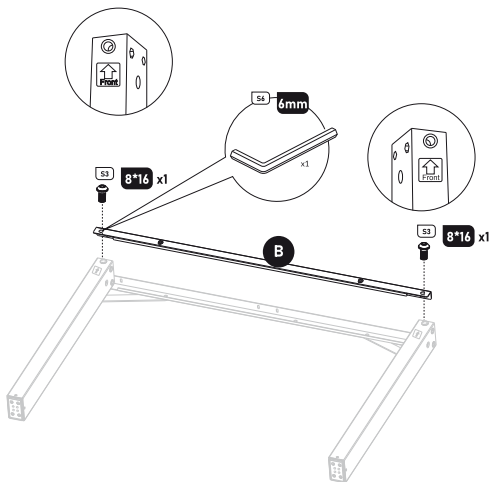

**MAKE SURE THE FRONT LABELS ARE IN THE SAME DIRECTION.**

# 3

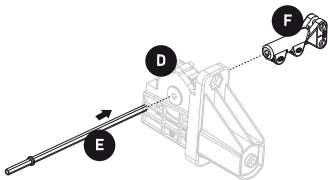

**STEP 1**

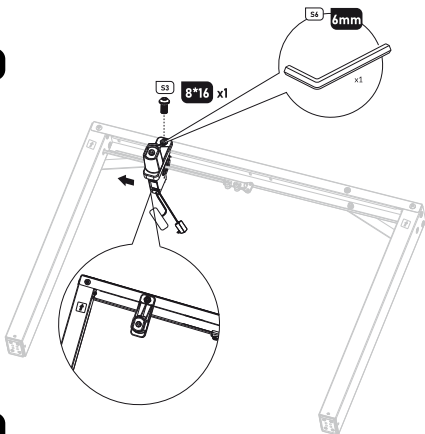

**STEP 2**

# 4

**STEP 1**

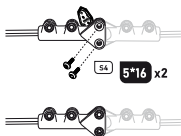
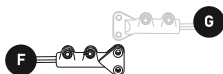
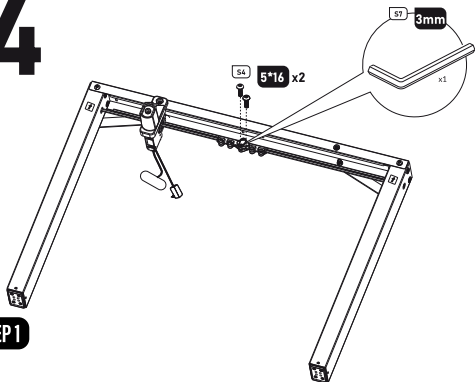

**STEP 2**

# 5

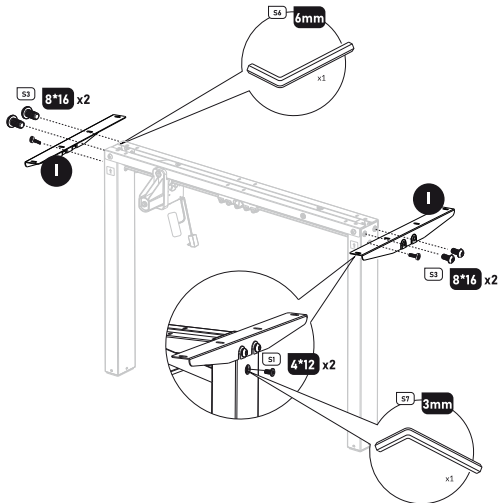



# 6

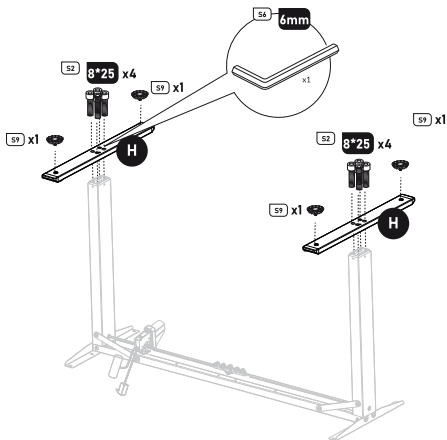

**PLEASE MAKE SURE THE TABLE LEGS ARE VERTICAL TO THE CONNECTING ROD.  
AND THEN TIGHTEN ALL THE SCREWS.**

# 7

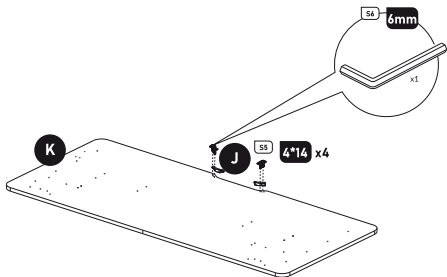

# 8

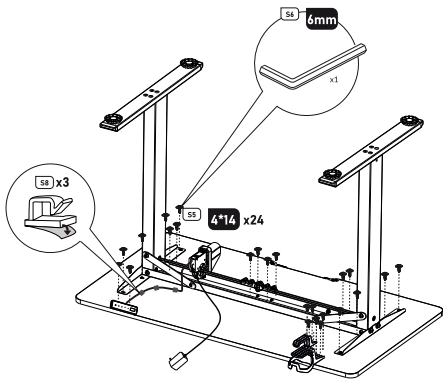

9

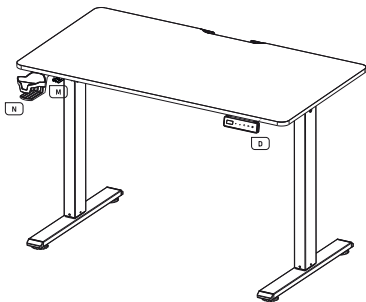
1100  
**TENSIO**

AFTER THE TABLE IS INSTALLED  
PLEASE PRESS THE  KEY TO START.

THE TABLE WILL BE AUTOMATICALLY DROP TO THE LOWEST POINT, STAY FOR 3 SECONDS, THEN RISE TO THE HIGHEST POINT, AND FINALLY RETURN TO THE INITIAL POSITION - SUCCESSFUL INSTALLATION.

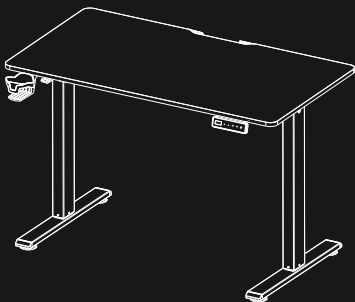

# DIABLO

CHAIRS



Permette il  
diversificare  
e rispettare

Assistenza

Registri

Obiettivo

INFORMATICA E SISTEMI